

Product and Accessories

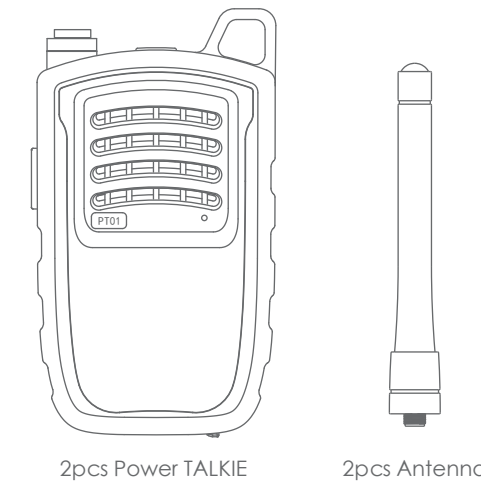

Accessories

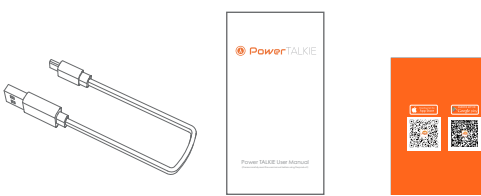

2pcs Micro usb cable 1pc User Manual 1pc QR code card

1

Initial Assembly

Install Antenna

Hold the bottom of the antenna and align it with the antenna connection seal on the top of the Power TALKIE. Next, turn the antenna clockwise until it is tightened.

Note: please ensure that the antenna is properly installed before using. If the antenna is not installed when using, the transmitter may be damaged.

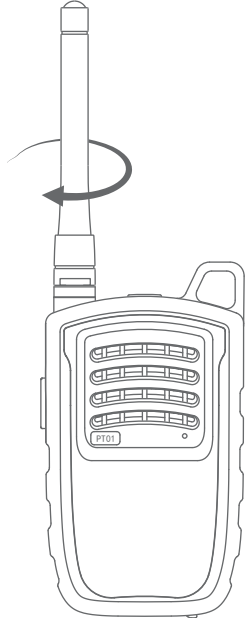

Connecting the charging cable

- Open the bottom waterproof cover, plug the micro usb cable to the usb power source to charge the Power TALKIE.
- Plug the usb cable to charge other devices.

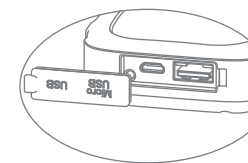

2

Function Sketch Diagram

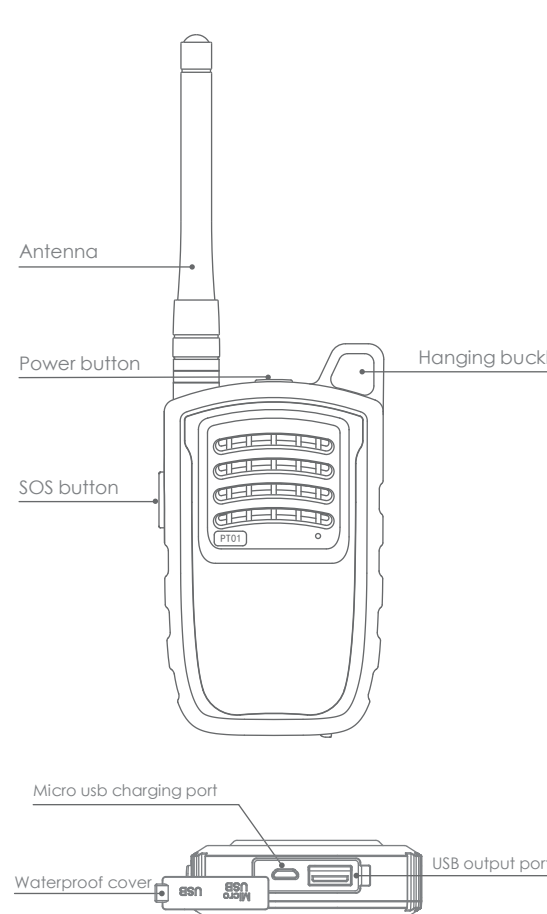

3

First Time Use

- Scan QR code or download Power TALKIE installation package in application store, then install.



(Scan QR code on the QR code card)

- Please ensure the Power TALKIE is turned on.
- Open the APP.
- Agree to permission demands.

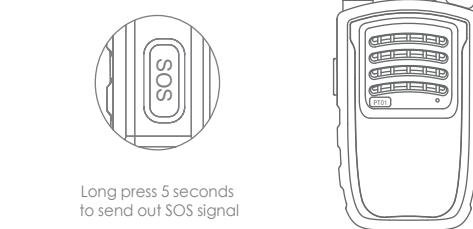
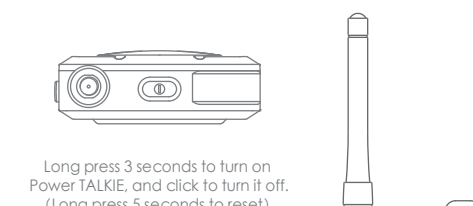

4

Available Functions

Function 1: Text messaging

Send text messages through our APP, when there is no cell service, or WiFi available.

Function 2: Voice messaging

Send voice messages through our APP, when there is no cell service, or WiFi available.

Function 3: Real-time talking

Participate in real time talking through APP, when there is no cell service, or WiFi available.

Supports group chat, when there is no cell service, or WiFi available.

Function 5: Location sharing

Share maps and GPS, when there is no cell service, or WiFi available.

Function 6: SOS

In the case of emergency, can send out the signal with location to all nearby who connect with Power TALKIE network.

Function 7: Charge your phone

Built with 6000mAh battery, can standby for 7 days and charge other devices as well.

Login with Account

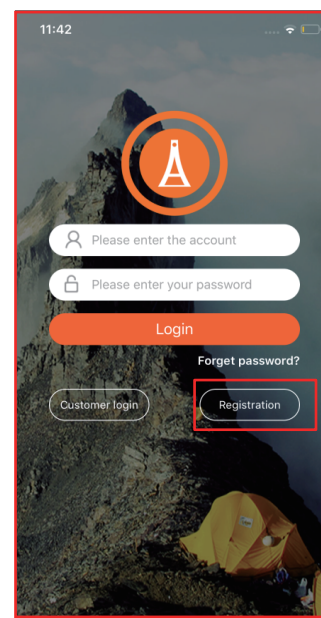

1. Please register an account before first time use. (If you don't register, you must continue as a guest.)
2. Select Registration icon to access the account registration interface.
3. Enter account and password to login directly if you already have an account.
4. Select guest login icon to skip account registration and go directly into APP.

5

Account Registration

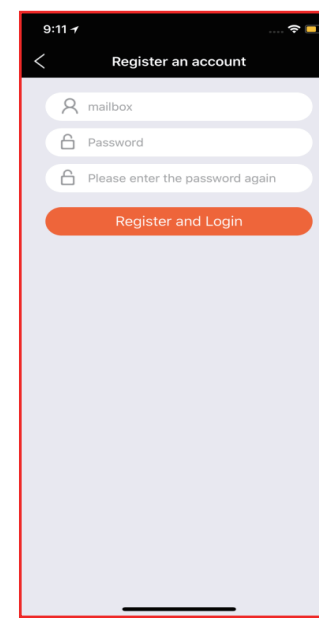

1. Enter email address.
2. Enter password.
3. Enter password again.
4. Click Register and Login button to register your account.

6

Connect Power TALKIE Device

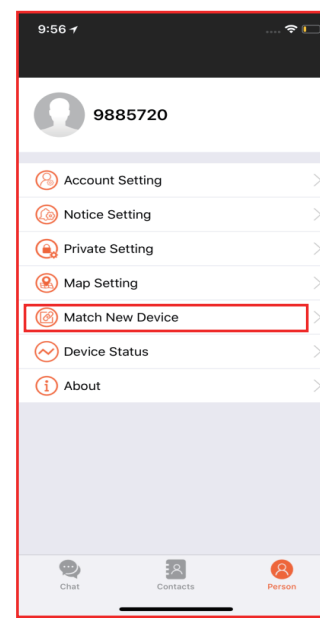

1. Open the APP.
2. Select Person.
3. Select Match New Device.

7

Connect Power TALKIE Device

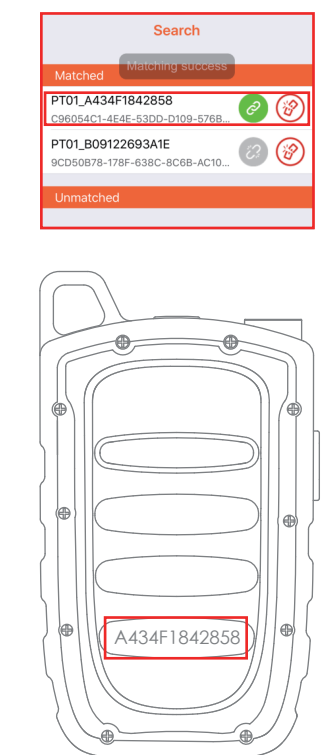

1. Check the ID number on the back of Power TALKIE.
2. Select same ID number in the APP to connect Power TALKIE.

8

Add Friend

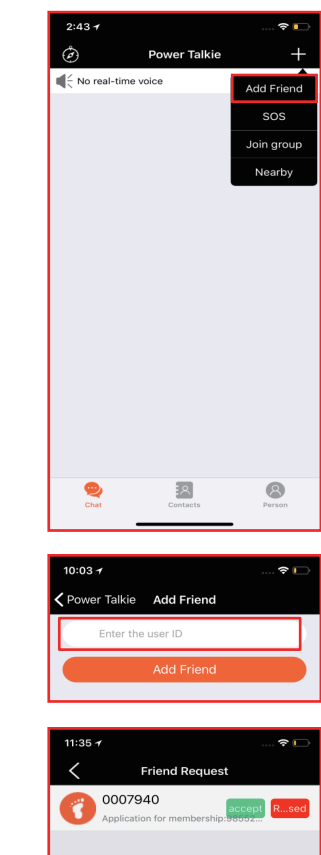

1. Select Chat.
2. Select "+".
3. Select Add Friend.
4. Enter the user ID.
5. Select Accept.

9

Create Group Chat

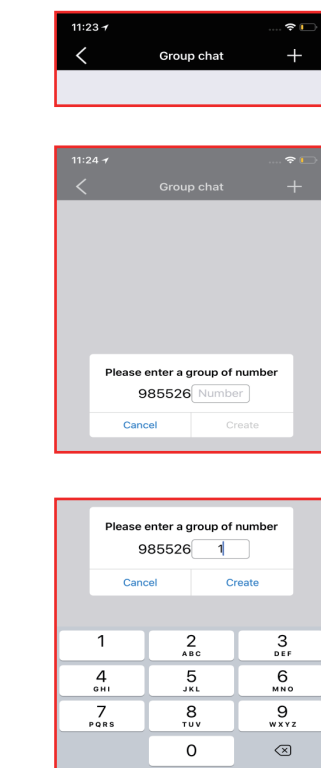

1. Select Contacts.
2. Select "+".
3. Select Group chat.
4. Enter group ID number.
5. Select Creat.

10

Apply to Join Group

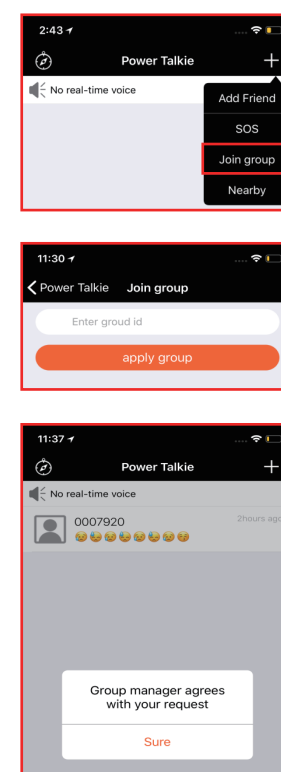

1. Select Chat.
2. Select "+".
3. Select Join group.
4. Enter the group ID.
5. Select Apply group.
6. Select Sure.

12

Group Manager Agree the Request

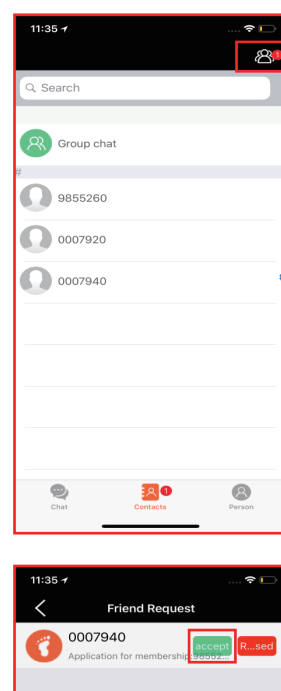

1. Select Contacts.
2. Select "+".
3. Select Accept.

13

Search Nearby User

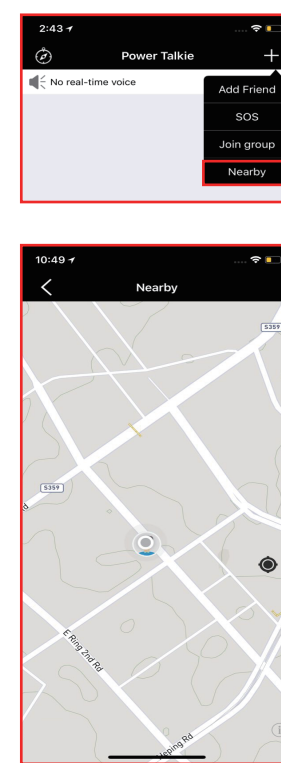

1. Select Chat.
2. Select "+".
3. Select Nearby.

14

Download Offline Map

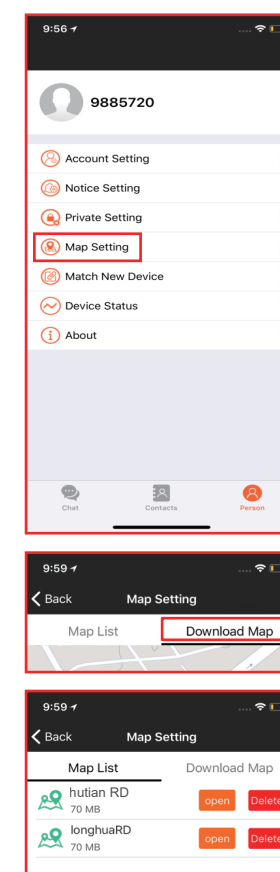

1. Select Person.
2. Map setting.
3. Download map.

15

Send SOS message

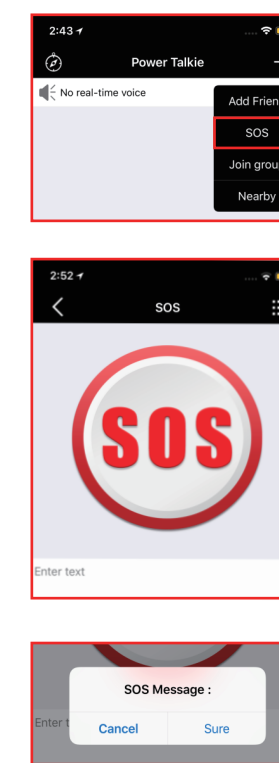

1. Select Chat.
2. Select "+".
3. Select SOS.
4. Enter text.
5. Press SOS button.
6. Select Sure.

16

Check SOS Message

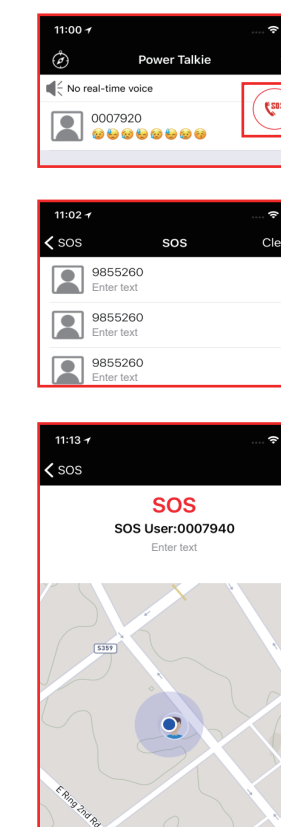

1. Select Chat.
2. SOS message.

17

Talking in Group Chat

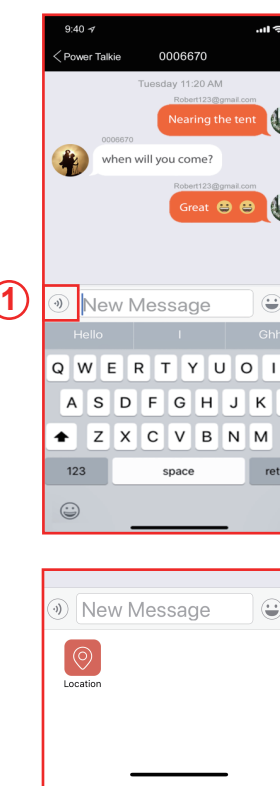

1. Select ①, switch to enter voice or text.
2. Select "+", you will find location icon.
3. Select Location to share location.

18

Troubleshooting

- Problem 1: Log in unsuccessfully.
- Answer: 1. Check if the network is connected normally.
2. Check if the password is correct.
3. Check whether your account is being used in by other users.
- Problem 2: Power TALKIE connection is abnormal.
- Answer: 1. Check whether Power TALKIE is in Bluetooth pairing status, the blue light should be flashing each second.
2. Check whether the phone turn on Bluetooth.
3. Check if distance between Power TALKIE and the phone is beyond the Bluetooth effective distance.
- Problem 3: Can't send out message successfully.
- Answer: 1. Check device matching in APP to determine whether it is connected to your Power TALKIE Bluetooth.
2. Check whether your friend is properly connected.
3. Check whether the send distance is beyond the effective communication distance.
4. Check whether your friend is in receiving message status mode.
- Problem 4: Can't charge successfully.
- Answer: 1. Check whether power or usb connection is normal.
2. Turn on Power TALKIE, then begin to charge the device, make sure red light is flashing. (Please note: there is no flashing light when turning off Power TALKIE).
- Problem 5: No sound prompt when receiving a message.
- Answer: 1. Check if mobile phone sound is turned on.
2. Check if APP notifications are turned on.
- Problem 6: Can't find people nearby.
- Answer: 1. Check whether your friend has a shared location.
2. You may need to wait up to 1 minute to find people nearby.
3. Ensure that the other side is not in the state of receiving broadcast.

19

Basic Parameters

Product specifications

Model: PT01
Transmitting power: 2W
Frequency: check APP for details.
Battery type: polymer lithium battery
Capacity of battery: 6000mAh
Work temperature: -20°C~60°C
Charging temperature: 0°C~40°C
Power connector: Micro USB
Output connector: USB
Input: DC 5V 2A
Output: DC 5V 2.4A
Rated voltage: 3.8V
Support bluetooth version: 4.2&above
Product size(without antenna): 196x72x26mm,
antenna length: 100mm
Net weight: 233g
Receiver sensitivity: -116dbm
IP67 class, and drop-proof
Delivery range(point to point):
Congested area(cities, forests): up to 3km
Open area(mountains, sea): up to 6km
Line of sight(mountain tops): up to 30KM

20

Warnings

Do not use Power TALKIE in below scenarios, because transmitting signal may affect electronic devices or medical devices.

- Near hospitals, pacemakers and other medical devices.
- Flammable areas such as gas stations.
- Aircraft, and other places easily interfered with by electronic devices.
- Any other area where the restrictions or warning of radio equipment are posted; If the Power TALKIE has the following abnormal conditions, please stop charging or using it immediately, turn off the power supply and contact the customer service department.
- If the Power TALKIE or charger is smoking or emitting a burning odor in the process of charging, please turn off the product immediately and remove out the power plug so as to prevent over heating, combustion, fire and explosion.

Additional notes

- Please do not place Power TALKIE in direct sunlight or near a heat source.
- Please do not operate near TVs or radios. (There is radio interference around TVs, walkie talkies or radios).
- Please do not disassemble or refit the Power TALKIE.

21

Warranty Policy

Warranty policy

From the date of purchase, within warranty period, free repair is available for product functional defects. The warranty period is one year.

Non-warranty policy

The following circumstances, but not limited to the following circumstances, belong within the non-warranty range, the user is responsible for all repair costs:

- Accidents caused by unauthorized disassembly, repair, modification, misuse, and failure or damage due to the use of non-original accessories.
- Exceeding the warranty period.
- Damage caused by force majeure.
- Failure of the product and its accessories due to personal reasons.
- Any damage caused by maintenance and adjustment not in accordance with the manual.
- The failure and damage not caused by the design, manufacture and quality of the product.

Customer service

Any questions concerning maintenance and safety, please consult the distributor or visit our official website at www.ptalkie.com for details.

22